

SEC-BLOCK-LOT-GRAVE-WAR-NAME

| | | | | | |
|---|---|----|---|---|----------------------|
| D | 2 | 32 | 1 | ⊙ | ALEXANDER, WM. |
| D | 3 | 30 | 1 | ⊙ | BAKER, FRANK H. JR. |
| D | 3 | 13 | 1 | ⊙ | BUCEY, E. B. |
| D | 3 | 9 | 1 | ⊙ | COFFLAND, SAMUEL. |
| D | 2 | 10 | 2 | ⊙ | ETZLER, LUTHER |
| D | 2 | 10 | 1 | ⊙ | ETZLER, MARTIN L. |
| D | 3 | 15 | 1 | ⊙ | FRANZELL, CHARLES. |
| D | 2 | 39 | 1 | ⊙ | GARY, SAM'L CLARK |
| D | 2 | 37 | 1 | ⊙ | HAWKINS, HUGH. A. |
| D | 2 | 6 | 1 | ⊙ | JONES, SERG. WM. H. |
| D | 4 | 46 | 1 | ⊙ | KUBALEK, JOSEPH. |
| D | 2 | 24 | 1 | ⊙ | LOCKWOOD, ANTHONY T. |
| D | 1 | 46 | 1 | ⊙ | MOSSER, JACOB |
| D | 5 | 47 | 1 | ⊙ | MOREL, JULIUS C. |
| D | 4 | 49 | 1 | ⊙ | NICHOLSON H.G. |
| D | 2 | 9 | 1 | ⊙ | OCHSENBEIN, WM. |
| D | 5 | 8 | 1 | ⊙ | PARK, JOHN R. |
| D | 1 | 16 | 1 | ⊙ | RADER, HIRAM. K. |
| D | 2 | 48 | 1 | ⊙ | RUSSELL, THOS. |
| D | 2 | 44 | 1 | ⊙ | STILWELL, W. N. |
| D | 4 | 28 | 1 | ⊙ | WILLIAMS, WILLIAM P. |
| D | 2 | 48 | 1 | ⊙ | YAUS, HARRY. |
| D | 2 | 48 | 1 | ⊙ | UNKNOWN |

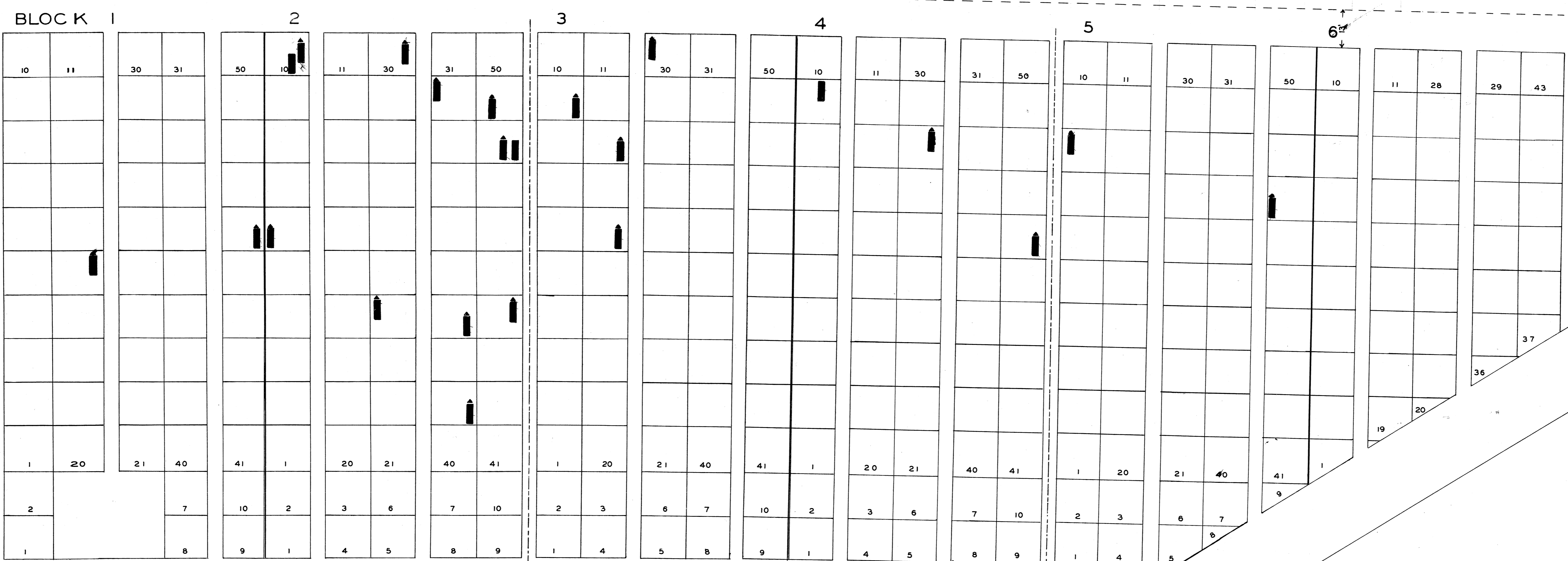

SEC-D.

Handwritten: Sec D

Handwritten: 100/100